

LIGHTMASTER COMPACT



The design of this performing and elegant asymmetric floodlight, makes the **LIGHTMASTER** range really complete. The innovative and highly efficient asymmetric optics make this device the most rational and performing instrument for professional lighting of sport facilities, sport halls, outdoor areas, events and shows in large open areas. Aesthetic, technical, photometric performance and flexibility of use, represent key features of **LIGHTMASTER** range since long time.

The **LIGHTMASTER COMPACT** floodlight was designed to illuminate:

- sport facilities,
- sport halls,
- outdoor areas,
- events and shows in large open areas.

FEATURES

- Fixture body, light and compact, manufactured in die cast aluminium, with primary alloy and low copper content with high weatherproof rating.
- Advanced construction design reduces weight and allows easy handling while both mounting and aiming activities.
- Elegant aluminum protractor scale to perform precise vertical aiming of the projector.
- Gear box for metal halide and high pressure sodium of 600, 1000 and 2000W of wattage:
 - CABLO IP 65 for Class I: in die cast aluminium.
 - CABLO IP 66 for Class II: in thermoplastic material, high thermal resistance and high resistance to air pollution.
 - Gear plate to be housed inside electric cabinet.
- The design with typical narrowing reduces wind resistance to a minimum.
- Insulation class: CL I and CL II.
- Floodlight body weight kg 17.
- Protection degree against external impacts: IK 08.
- The fixture is approved for nominal temperature of 35°C. Thus, according to EN 60598-1, the fixture can be used, for discontinuous periods, at 45°C.
- Certifications ENEC, standard reference EN 60598-1 / EN 60598-2-5
- Hot Restrike version with one security knife switch for double ended with short arc lamp, available on request.

MOUNTING AND LAMP REPLACEMENT

The **LIGHTMASTER** floodlight has a strong hot dipped galvanized steel fixing bracket. A series of equidistant holes allows safe fixing and orientation. The lamp is located by opening the rear cover by using two strong stainless steel quick release clips. In the double-ended lamp versions, the opening of the rear cover automatically disconnects the power by means of high resistant switches. Lamp replacement is achieved by opening the cover housing at an angle of 110°. Accurate reproduction of the light distribution pattern is guaranteed by the two-point fixing of the transversely positioned lamp and by tight design tolerances of the lamp position in relation to the optical system.

OPTICAL SYSTEMS

XA SYSTEM:

Trapezoidal asymmetric optics with two emission types: intensive and wide beam

- for double ended, short arc 1000W lamps

Lighting output ratio: more than 75%

Plane of maximum intensity: at 56° from the vertical

- for double ended, long arc 1000W lamps

Lighting output: more than 70%

Plane of maximum intensity: at 52° from the vertical

- for E 40 1000W lamps

Lighting output ratio: more than 75%

Plane of maximum intensity: at 48° from the vertical

- for E 40 SAP T 600W lamps

Lighting output ratio: more than 80%

Plane of maximum intensity: at 48° from the vertical.

XD SYSTEM:

Asymmetrical Paraellissoidal Rotational[®] optics (system patented by Fael) allow to obtain angles of asymmetry and maximum intensities significantly higher than those obtainable by means of the traditional asymmetric reflectors.

Two types of intensive emissions D1 and D2:

- for double ended, short arc 1000W lamps:

Lighting output ratio at 80%

Plane of maximum intensity: at 56° from the vertical.

- for double ended, long arc 1000W lamps:

Lighting output ratio at 70%

Plane of maximum intensity: at 56° from the vertical.

All floodlights may be provided with different aluminum louvres, painted in silver colour, in order to switch the plane of maximum intensity of 6° and 12°.

SUITABLE LAMPS

- MH 1000 W double ended, short arc Osram type, long arc Philips type
- MT 1000 W E40
- ST 1000 W E40
- ST 600 W E40

PHOTOMETRIC DATA

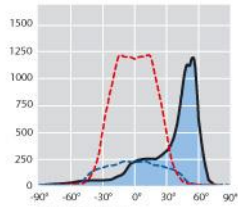

MD 1000W short arc

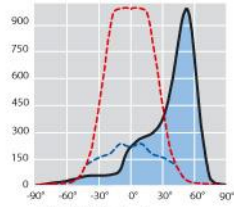

MD 1000W short arc

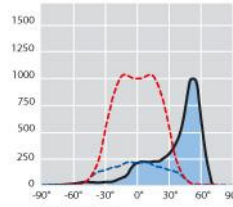

MD 1000W long arc

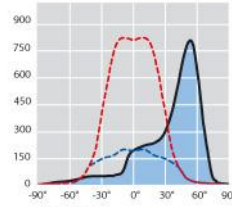

MD 1000W long arc

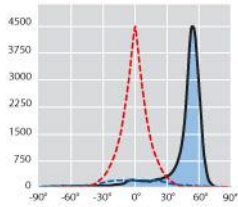

MD 1000W short arc

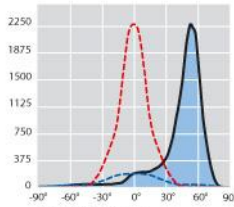

MD 1000W short arc

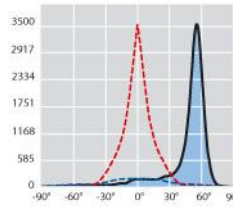

MD 1000W short arc

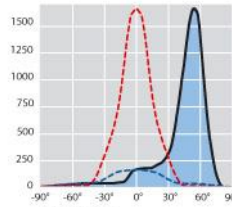
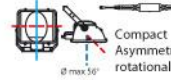

MD 1000W long arc

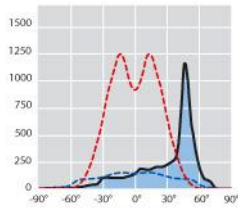
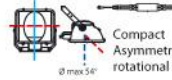

MT(JM-T) 1000 E40

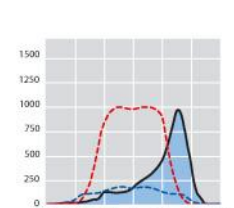

MT(JM-T) 1000 E40

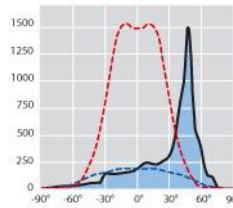

ST(SAP-T) 1000 E40

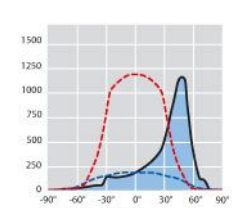

ST(SAP-T) 1000 E40

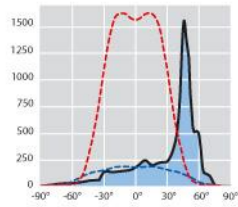

ST(SAP-T) 600 E40

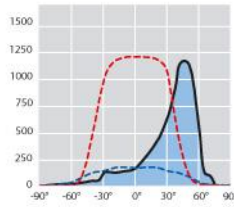

ST(SAP-T) 600 E40



TECHNICAL DRAWINGS

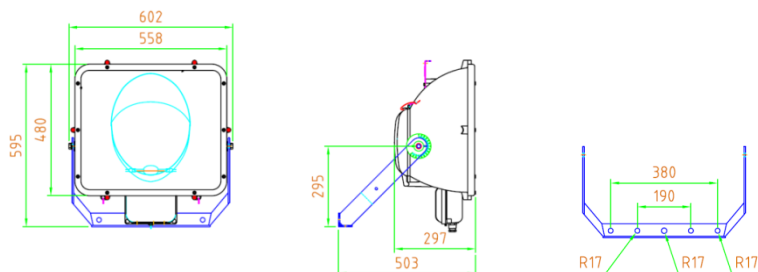

LIGHTMASTER Compact - Asymmetrical Paraellissoidale Rotational – Double ended 1000W

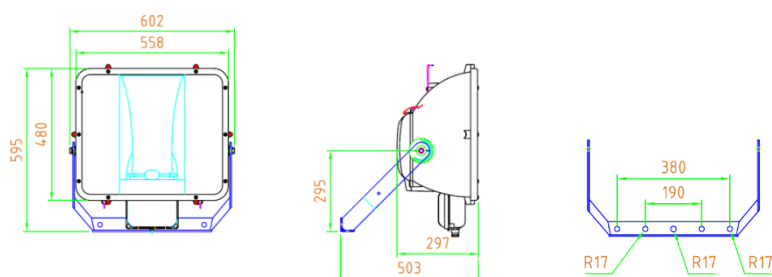

LIGHTMASTER Compact - Trapezoidal asymmetric - Double ended 1000W

APPLICATIONS



Sport Facilities



Large Areas



Airports

CERTIFICATIONS



ACCESSORIES



Alumium anti-glare louvre (6° and 12°)

Release: September 2012